

Distributor racks

TE 7000 open Catalogue 33, page 110

DK 7000.940

Front view

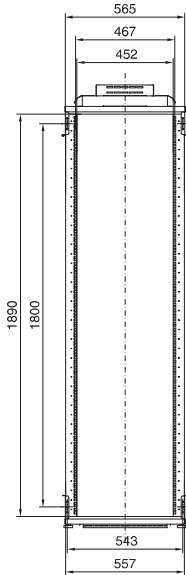

Top view

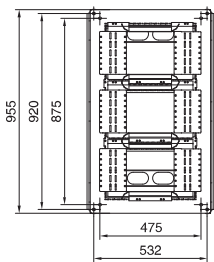

DK 7000.944

Front view

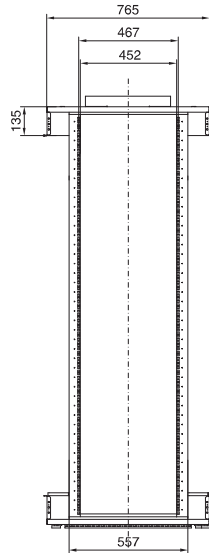

Top view

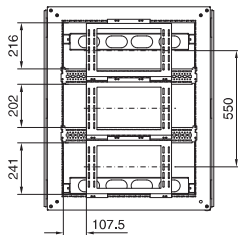

Side view

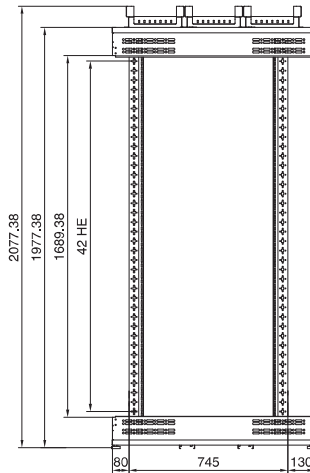

HE = U

Data Rack Catalogue 33, page 111

Front view

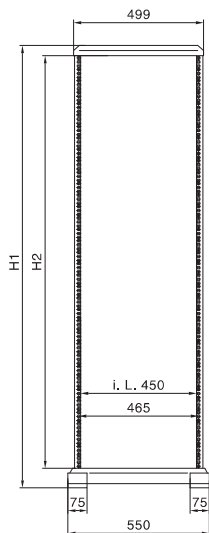

Side view

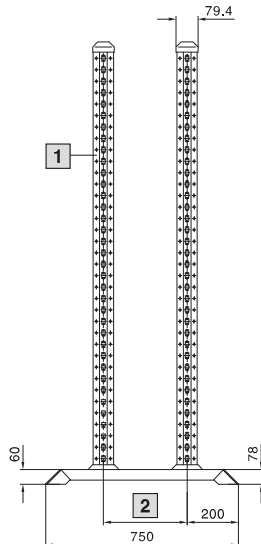

- 1 Second pair of mounting angles
DK 7296.000/31 U
DK 7297.000/36 U
DK 7298.000/40 U
DK 7299.000/45 U

- 2 On a 50 mm pitch pattern
(min. 150 – max. 350)

i.L. = Clearance width

Model No. DK	U	Height dimensions mm	
		H1	H2
7391.000	31	1500	i.L. 1382
7396.000	36	1722	i.L. 1604
7400.000	40	1900	i.L. 1782
7445.000	45	2122	i.L. 2004