

### Lessenaar-bovendelen

Breedte 600/800 mm  
TP 6720.500, TP 6721.500

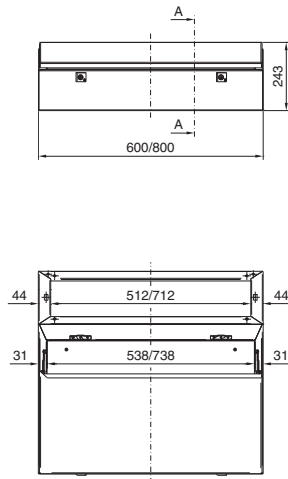

Breedte 1200/1600 mm  
TP 6722.500, TP 6723.500

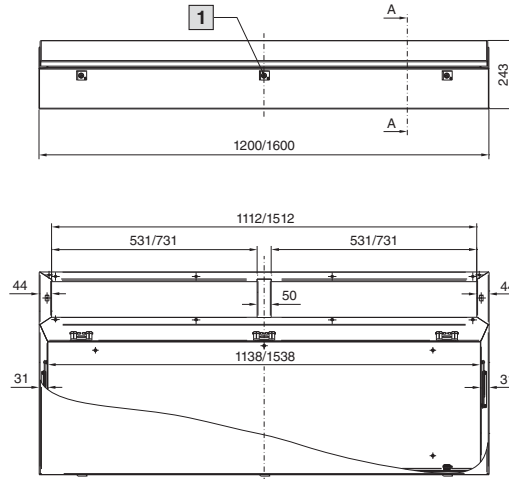

Doorsnede A - A

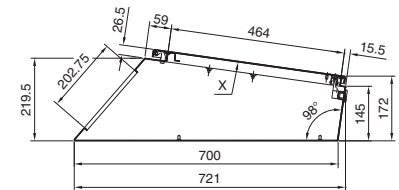

1 Alleen bij een breedte van 1600 mm

**Opmerking:**

- Aanzicht X, zie pagina 2

### Lessenaar-middelen, voorbereid voor lessenaar-bovendeel

Breedte 600/800 mm  
TP 6714.500, TP 6715.500

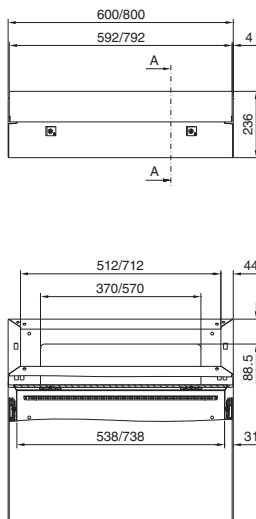

Breedte 1200/1600 mm  
TP 6716.500, TP 6717.500

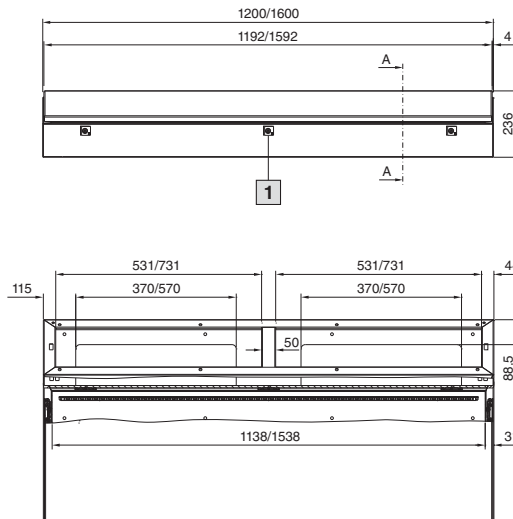

Doorsnede A - A

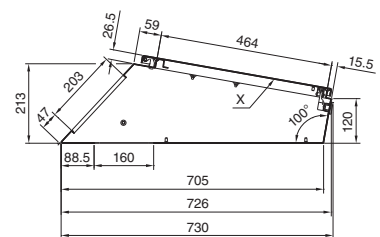

1 Alleen bij een breedte van 1600 mm

**Opmerking:**

- Aanzicht X, zie pagina 2

# Kastsystemen

## TopConsole-systeem TP

### Lessenaar-middelen, achter met scharnierend deksel

Breedte 600/800 mm  
TP 6710.500, TP 6711.500

Breedte 1200/1600 mm  
TP 6712.500, TP 6713.500

Doorsnede A – A

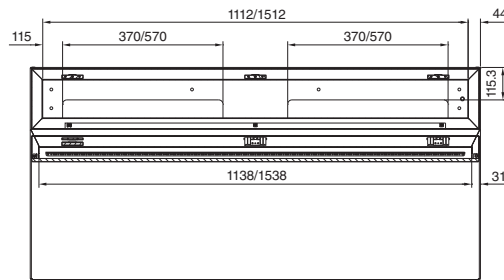
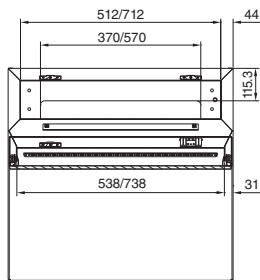
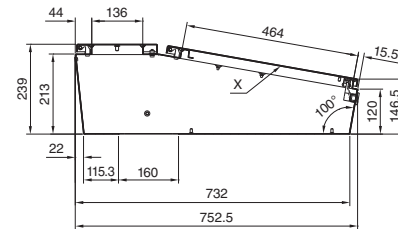
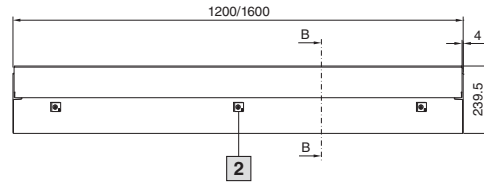
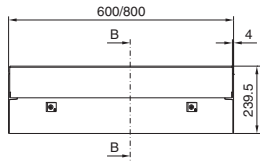

Aanzicht X

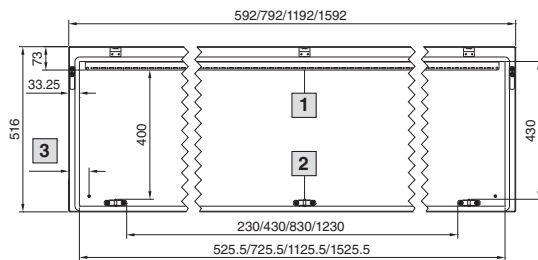

- 1 Vervalt bij breedte 600/800 mm
- 2 Alleen bij een breedte van 1600 mm
- 3 Breedte = 600/800/1200 = 63,5 mm  
Breedte = 1600/163,5 mm

### Lessenaar-onderdelen, diepte 400 mm

Breedte 600/800 mm  
TP 6700.500, TP 6701.500

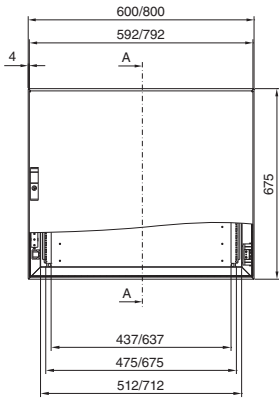

Breedte 1200/1600 mm  
TP 6702.500, TP 6703.500

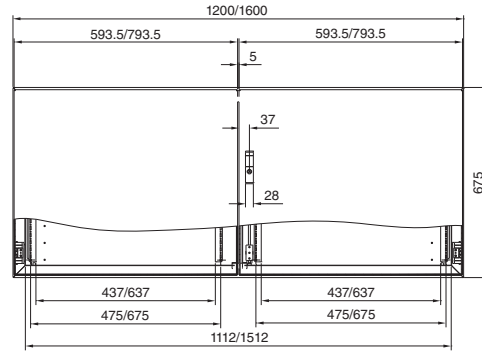

Doorsnede A – A

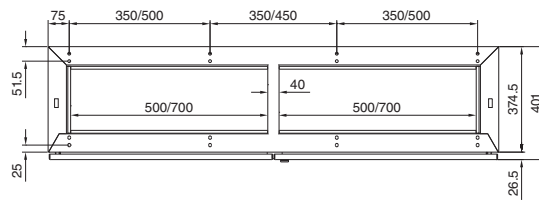
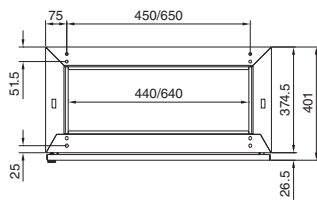
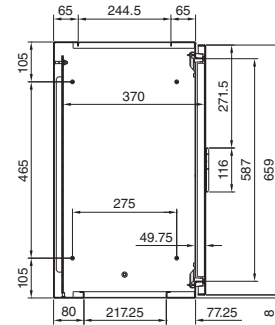

Montage-uitsparing

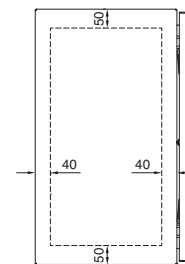

Montageplaat

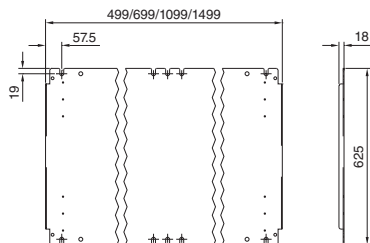

# Kastsystemen

## TopConsole-systeem TP

### Lessenaar-onderdelen, diepte 500 mm

Breedte 600/800 mm  
TP 6704.500, TP 6705.500

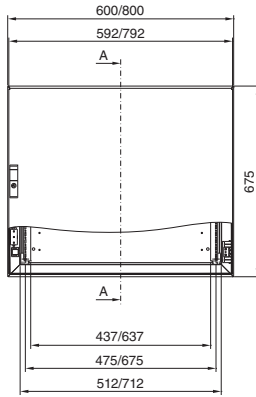

Breedte 1200/1600 mm  
TP 6706.500, TP 6707.500

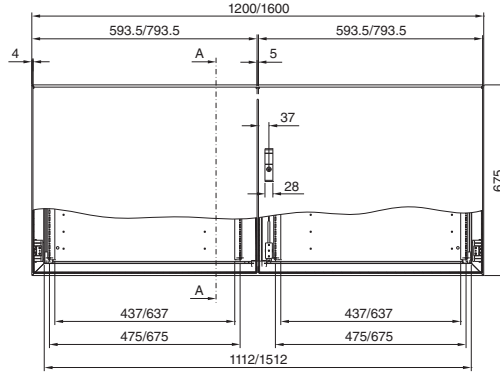

Doorsnede A – A

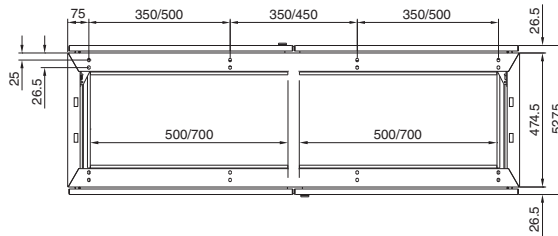
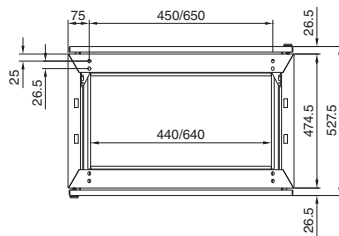
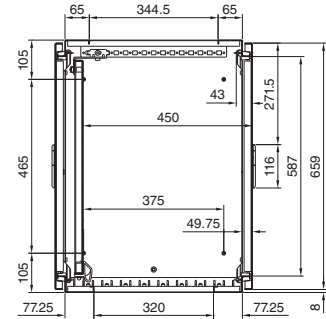

Montage-uitsparing

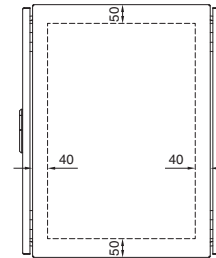

Montageplaat

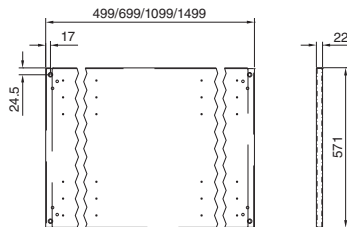

### Combinatiemogelijkheden

Opbouw 3-delig

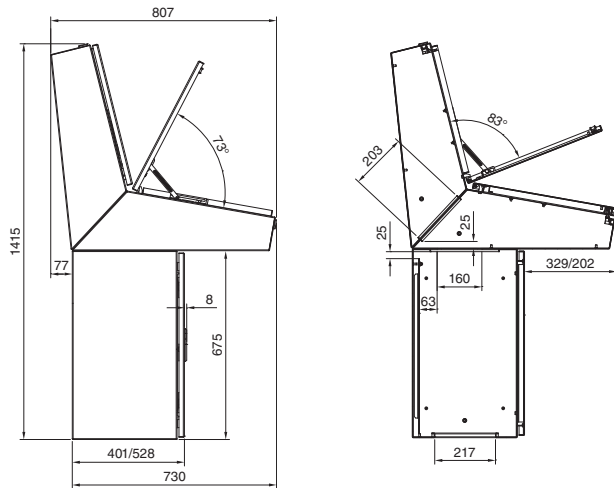

Opbouw 2-delig

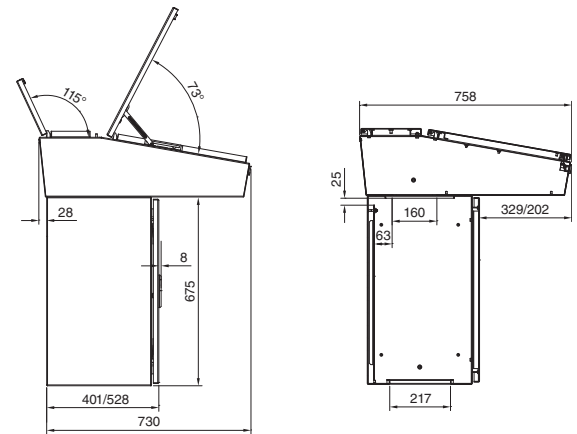

Opbouw 1-delig

