

Pulpetöverdelar

Bredd 600/800 mm
TP 6720.500, TP 6721.500

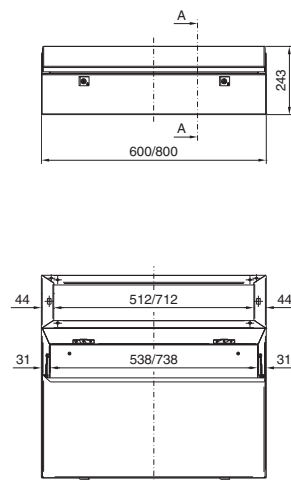

Bredd 1200/1600 mm
TP 6722.500, TP 6723.500

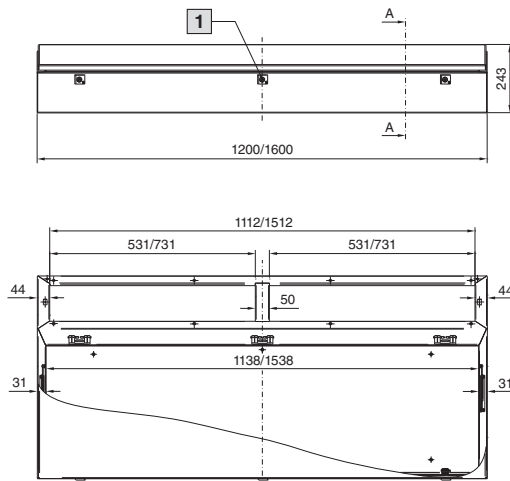

Snitt A – A

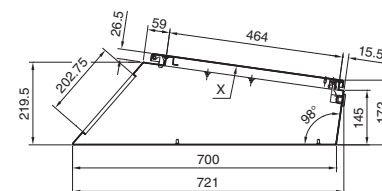

1 Endast vid en bredd på 1600 mm

Observera:
– Vy X, se sidan 2

Pulpetmellandelar, förberedda för pulpetöverdel

Bredd 600/800 mm
TP 6714.500, TP 6715.500

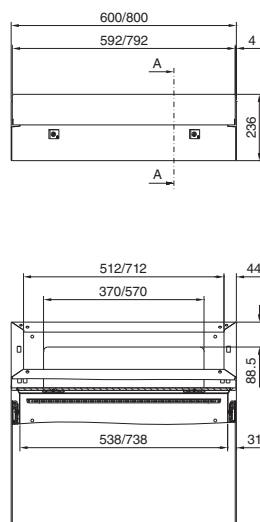

Bredd 1200/1600 mm
TP 6716.500, TP 6717.500

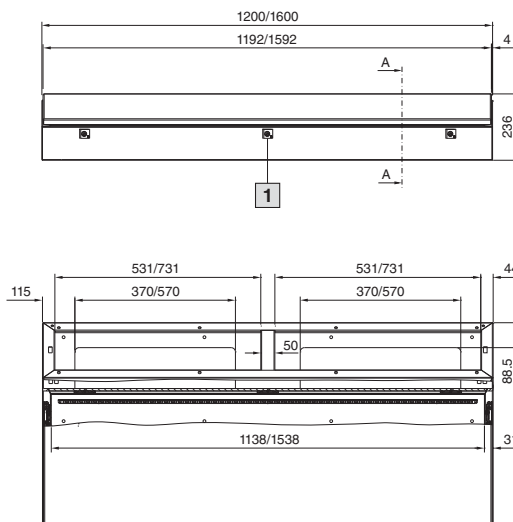

Snitt A – A

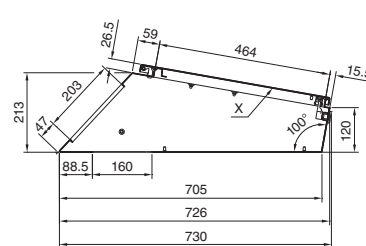

1 Endast vid en bredd på 1600 mm

Observera:
– Vy X, se sidan 2

Apparatskåp

TopPult-system TP

Pulpetmellandelar, baktill med gångjärnsförsedda lock

Bredd 600/800 mm
TP 6710.500, TP 6711.500

Bredd 1200/1600 mm
TP 6712.500, TP 6713.500

Snitt A – A

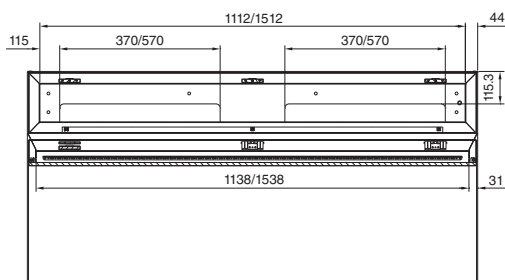
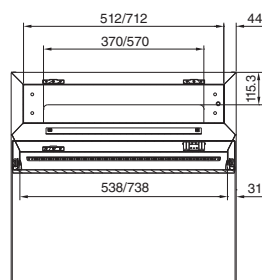
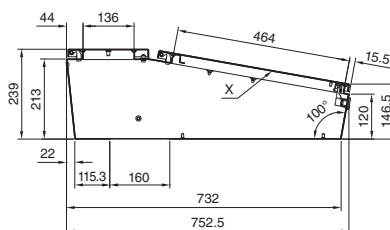
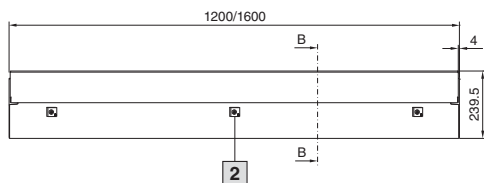
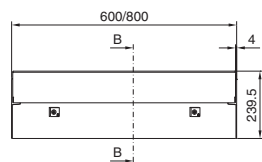

Vy X

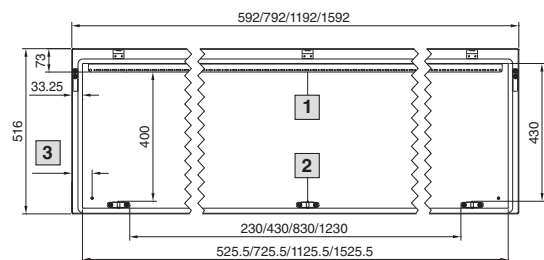

- 1 Utgår vid bredd 600/800 mm
- 2 Endast vid en bredd på 1600 mm
- 3 Bredd = 600/800/1200 = 63,5 mm
Bredd = 1600/163,5 mm

Pulpetunderdelar, djup 400 mm

Bredd 600/800 mm
TP 6700.500, TP 6701.500

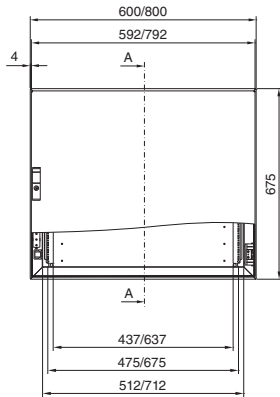

Bredd 1200/1600 mm
TP 6702.500, TP 6703.500

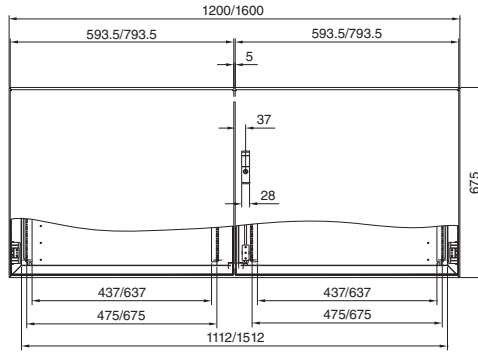

Snitt A – A

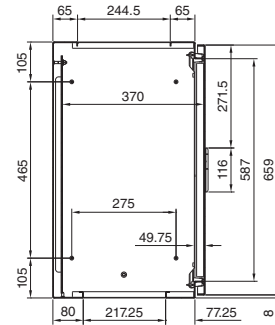

Montagehålbild

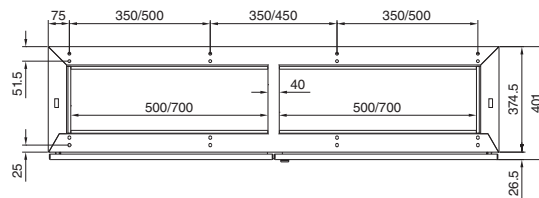
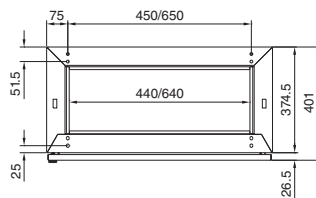
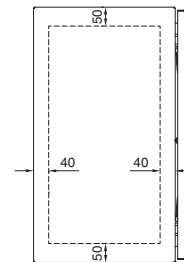

Montageplåt

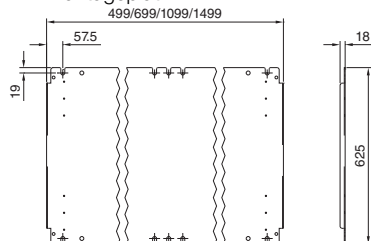

Apparatskåp

TopPult-system TP

Pulpetunderdelar, djup 500 mm

Bredd 600/800 mm
TP 6704.500, TP 6705.500

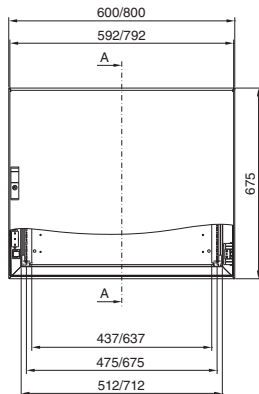

Bredd 1200/1600 mm
TP 6706.500, TP 6707.500

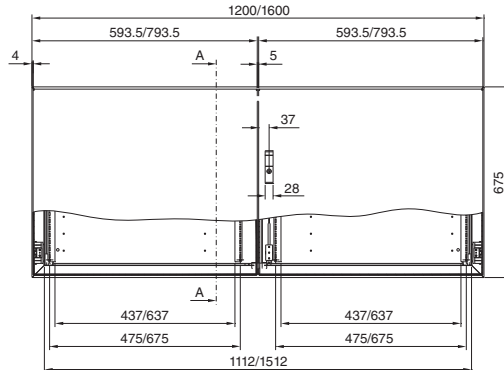

Snitt A - A

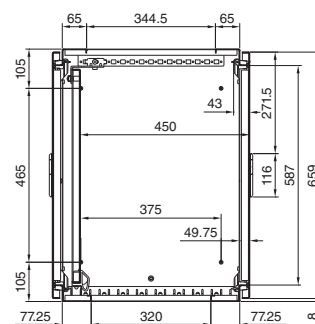

Montagehålbild

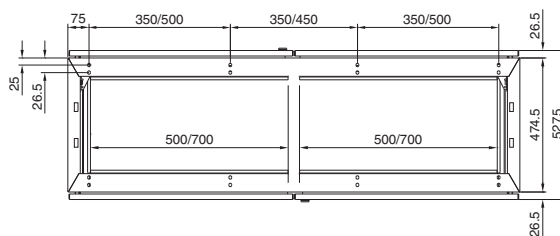
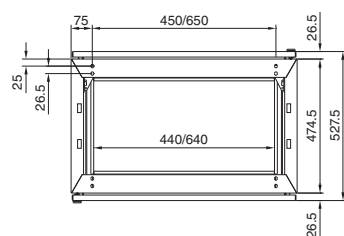
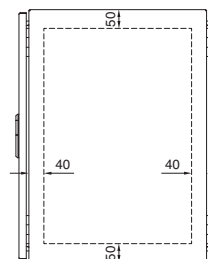

Montageplåt

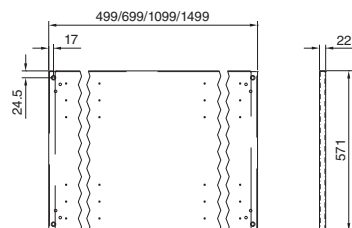

Kombinationsmöjligheter

3-delat utförande

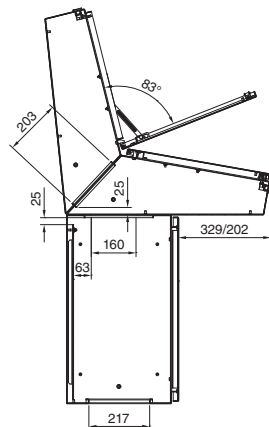
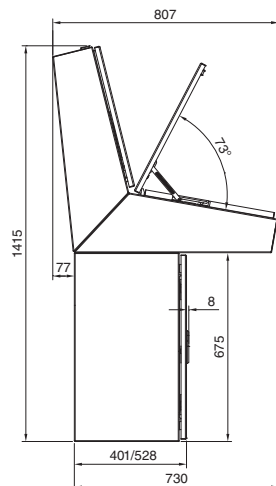

2-delat utförande

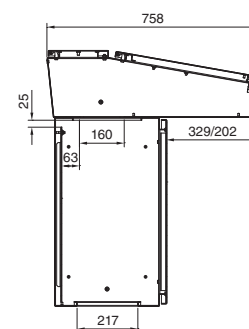
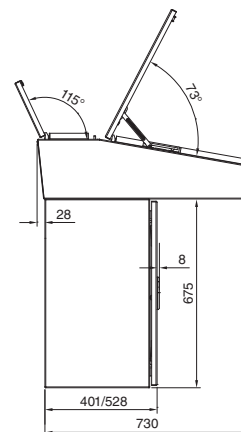

1-delat utförande

