

Skabe

Standerpulte TP

Standerpulte TP

Bredde 600/800 mm
TP 6746.500, TP 6748.500

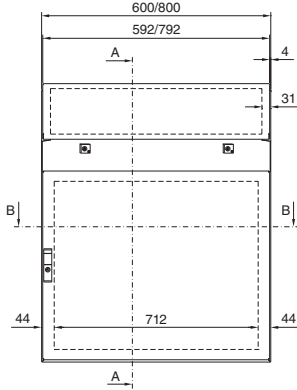

Bredde 1000/1200 mm
TP 6740.500, TP 6742.500

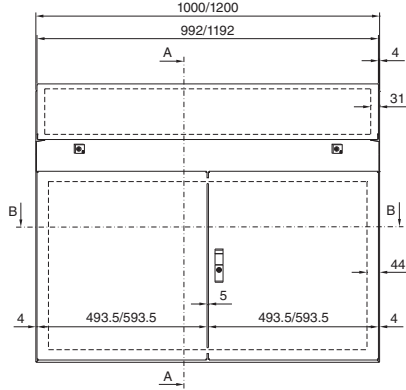

Sektion A - A

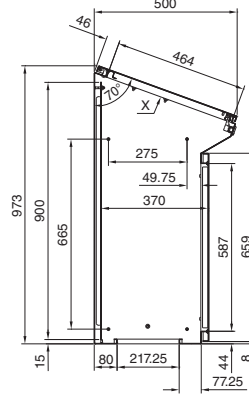

Montageudskæring

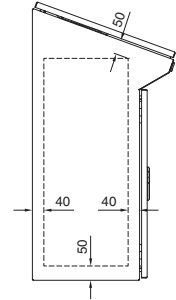

Sektion B - B

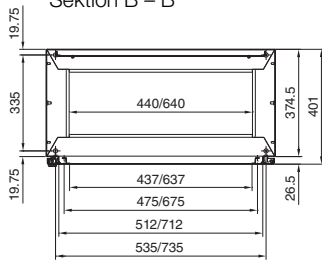

Sektion B - B

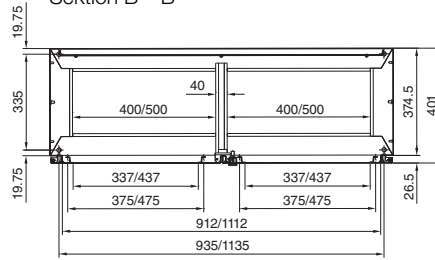

Montageplade

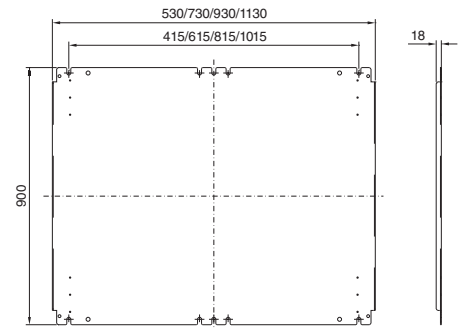

Set i retning X

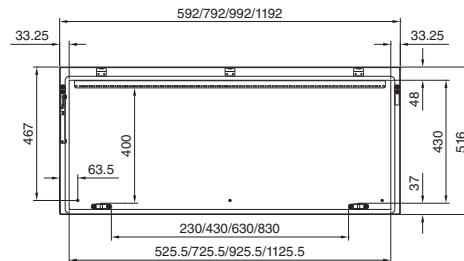

Universalpulte TP Stålblade

Med kort frontlåde
TP 2694.500

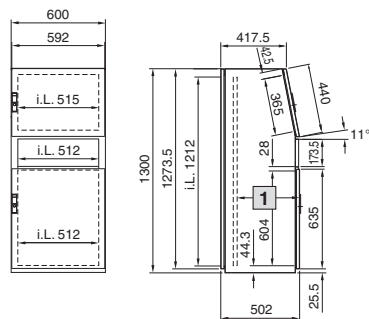

Med høj frontlåde
TP 2695.500

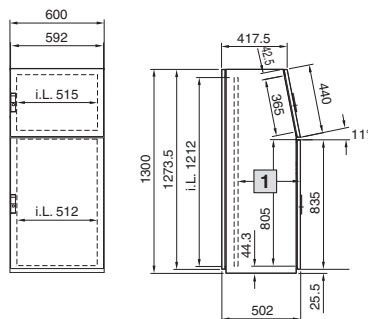

Montageplade

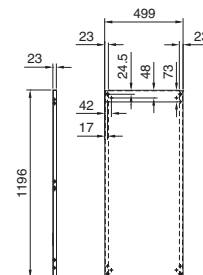

1 Fra 200 til 400 mm, regulerbart
i trin på 25 mm

i.L. = Clearance width