

控制机柜

立式控制台 TP

单斜面立式控制台 TP

宽度 600/800 mm
TP 6746.500, TP 6748.500

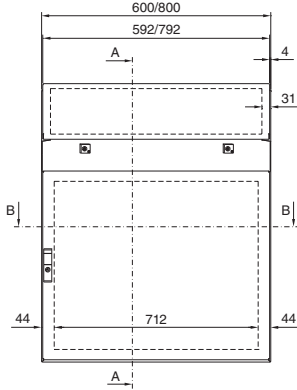

宽度 1000/1200 mm
TP 6740.500, TP 6742.500

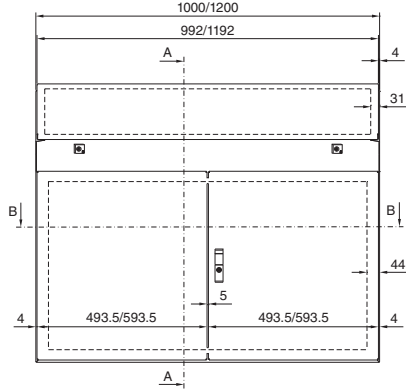

A - A 截面

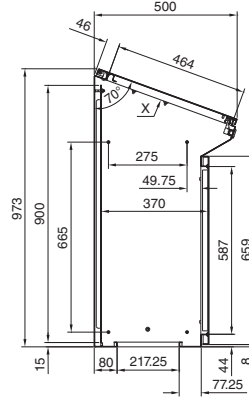

安装开口截面

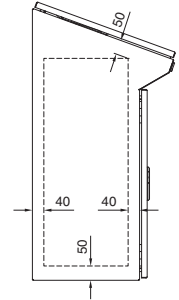

B - B 截面

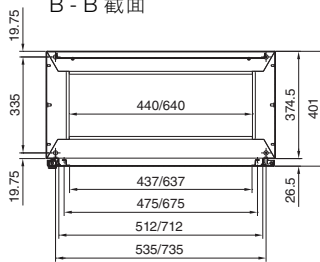

B - B 截面

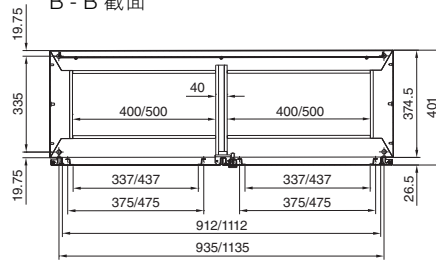

安装板

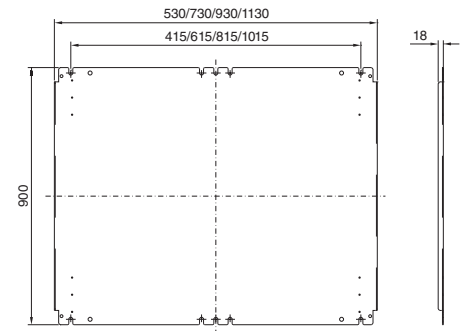

X 向视图

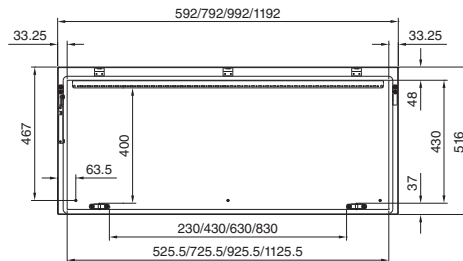

通用琴式控制台 TP 钢板

带较矮低的前门
TP2694.500

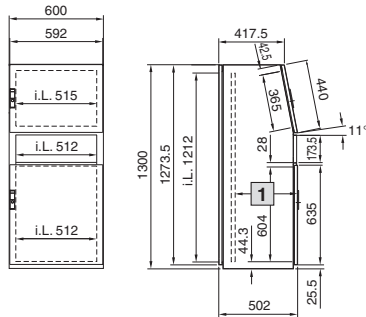

带较高的前门
TP2695.500

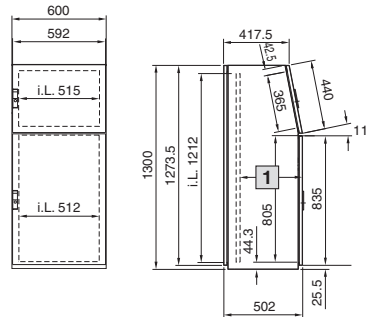

安装板

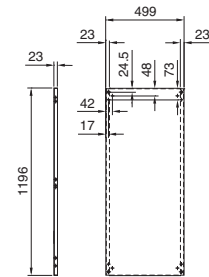

1 从 200 mm 至 400 mm 以 25 mm 间距为单位可调