

琴式控制台上部结构

宽度 600/800 mm
TP 6720.500, TP 6721.500

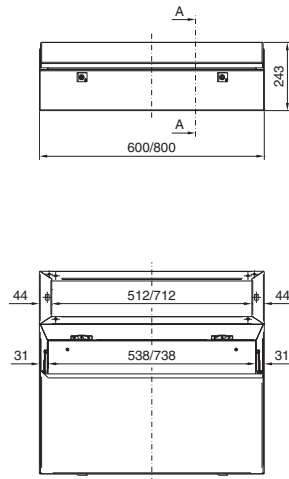

宽度 1200/1600 mm
TP 6722.500, TP 6723.500

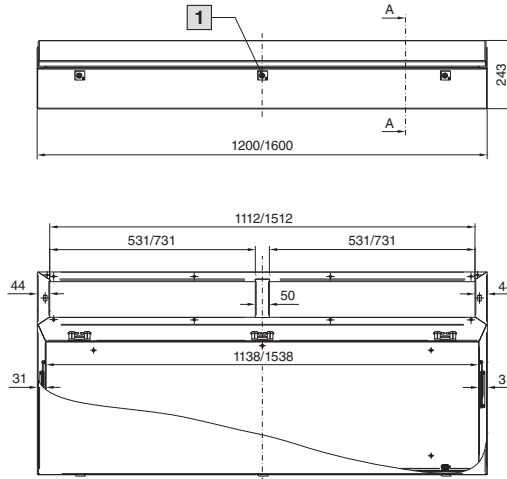

A - A 截面

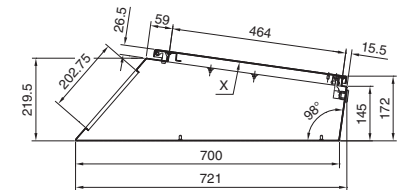

1 只适用于宽度为 1600 mm 的情况

说明:
- 视图 X, 参见页码 2

琴式控制台中部结构, 预备用于琴式控制台上部结构

宽度 600/800 mm
TP 6714.500, TP 6715.500

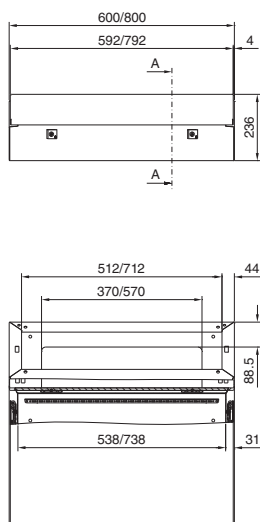

宽度 1200/1600 mm
TP 6716.500, TP 6717.500

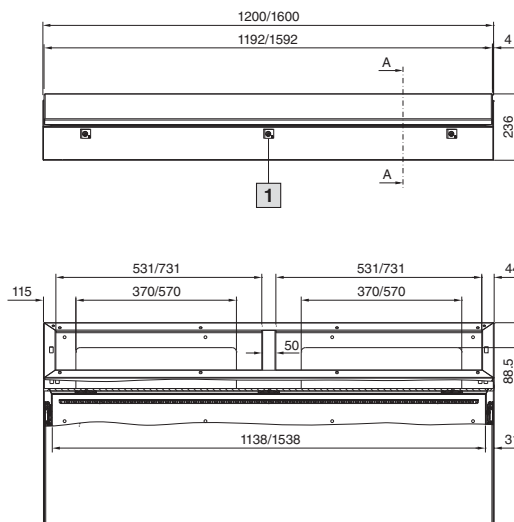

A - A 截面

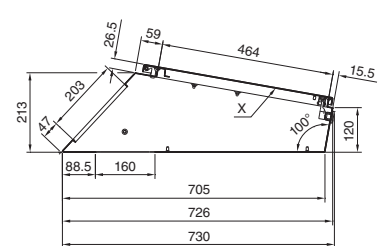

1 只适用于宽度为 1600 mm 的情况

说明:
- 视图 X, 参见页码 2

控制机柜

TopPult 系统 TP

琴式控制台中部结构，后面与盖板用铰链固定

宽度 600/800 mm
TP 6710.500, TP 6711.500

宽度 1200/1600 mm
TP 6712.500, TP 6713.500

A - A 截面

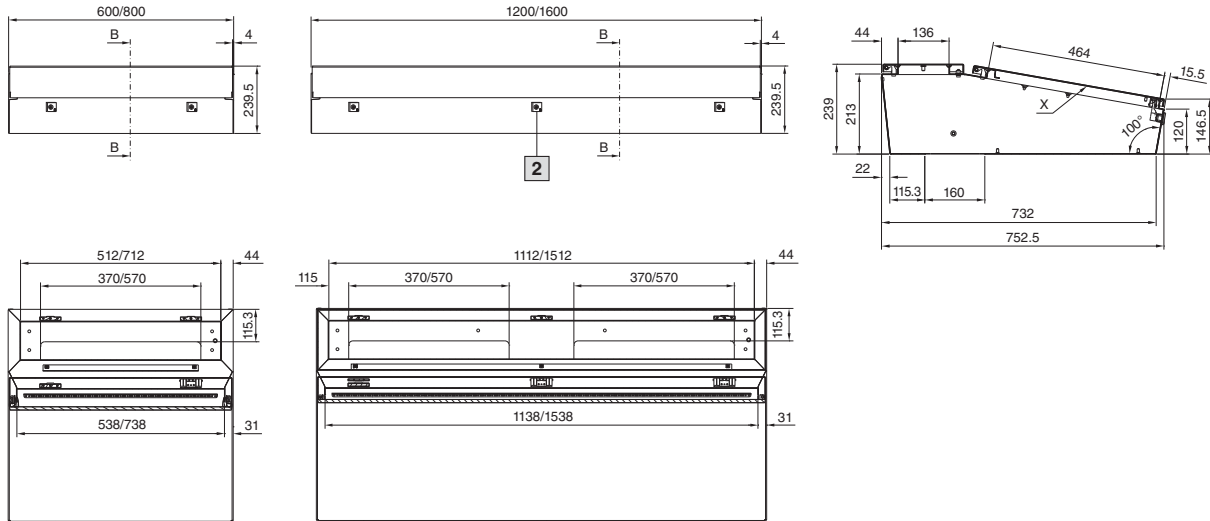

视图 X

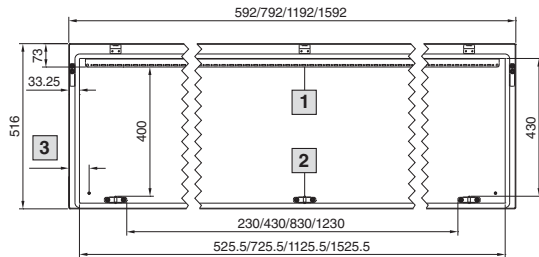

- 1 宽度 600/800 mm 时不适用
- 2 只适用于宽度为 1600 mm 的情况
- 3 宽度 = 600/800/1200 = 63.5 mm
宽度 = 1600/163.5 mm

琴式控制台底部结构，深度 400 mm

宽度 600/800 mm
TP 6700.500, TP 6701.500

宽度 1200/1600 mm
TP 6702.500, TP 6703.500

A - A 截面

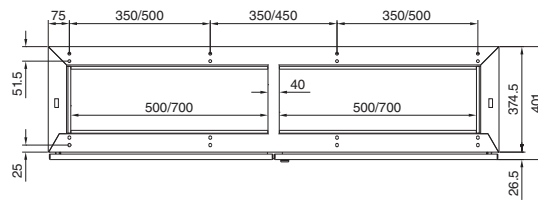
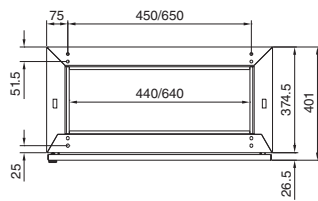
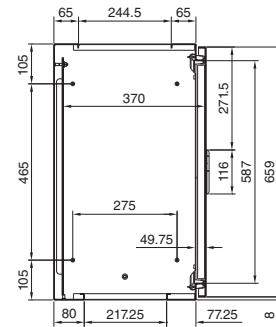
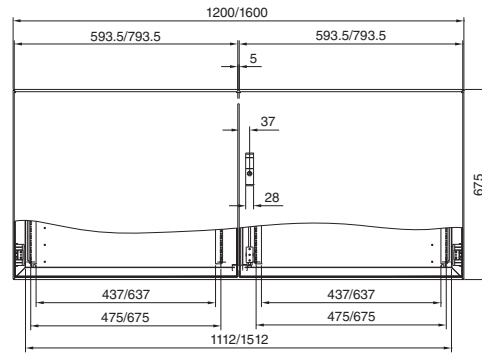
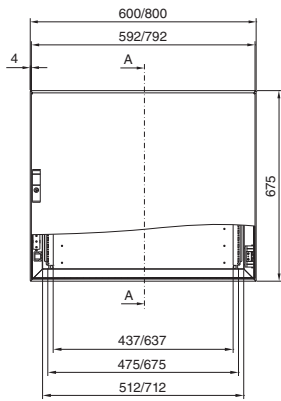

安装开口截面

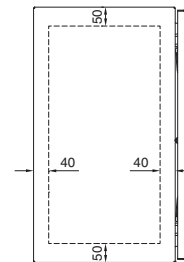

安装板

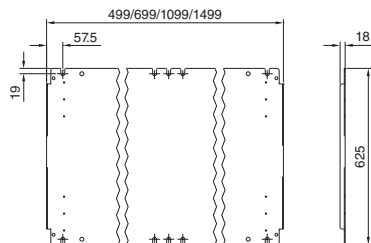

控制机柜

TopPult 系统 TP

琴式控制台底部结构，深度 500 mm

宽度 600/800 mm
TP 6704.500, TP 6705.500

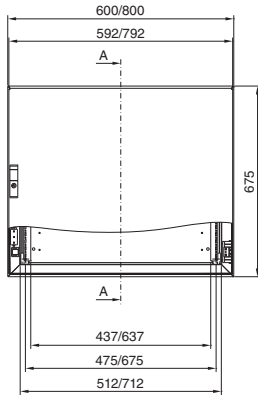

宽度 1200/1600 mm
TP 6706.500, TP 6707.500

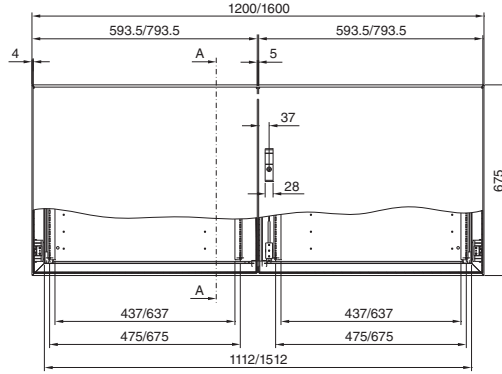

A - A 截面

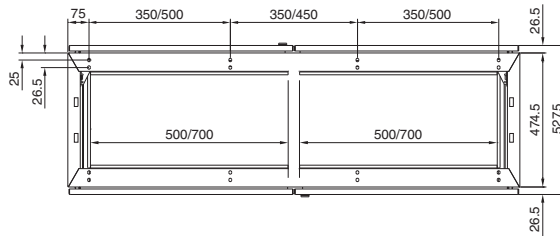
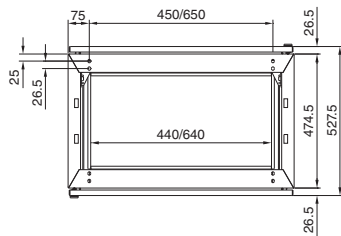
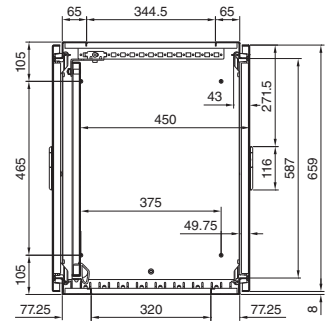

安装开口截面

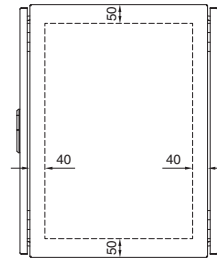

安装板

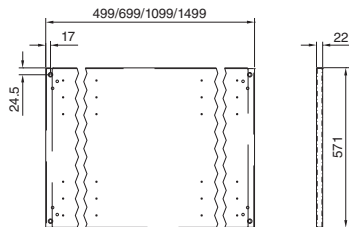

组合方式

3 段式结构

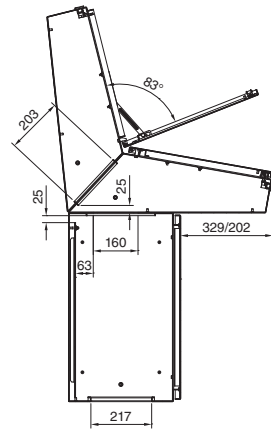
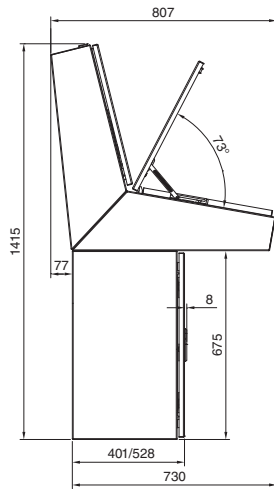

2 段式结构

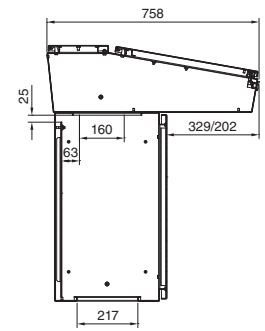
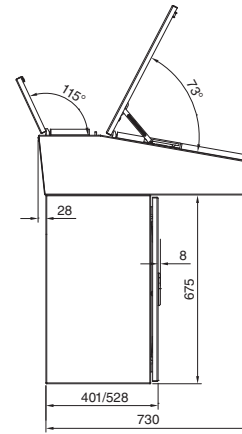

1 段式结构

