

Enclosures

Stainless steel

One-piece consoles

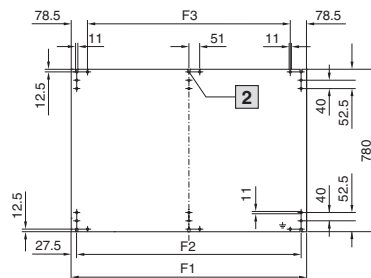
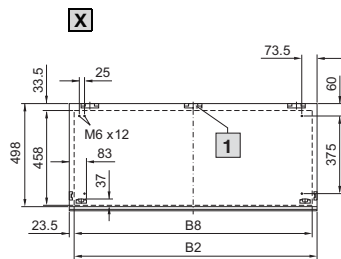
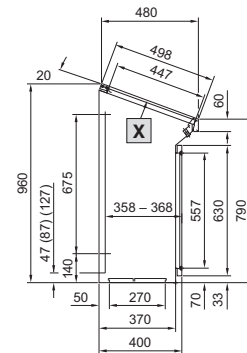
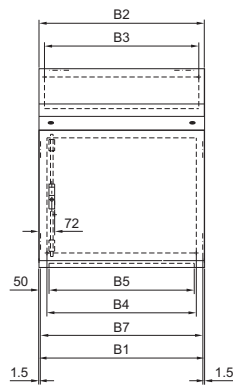
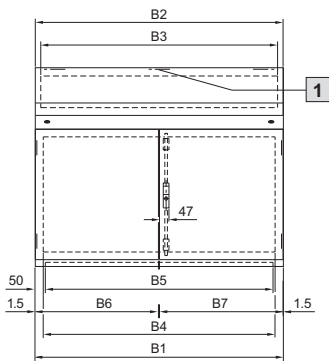

- 1 Hinge only for TP 2686.600
- 2 Not applicable to TP 2683.600/ TP 2684.600
- X Cover, interior view

Model No. TP	2683.600	2684.600	2685.600	2686.600
Width (B1) mm	600	800	1000	1200
Height mm	960			
Depth mm	400 /480			
B2 = Width of cover	597	797	997	1197
B3 = Clearance width, top	544	744	944	1144
B4 = Clearance width, front	524	724	924	1124
B5 = Clearance width, bottom	500	700	900	1100
B6 = Width of adjacent door	-	-	495	595
B7 = Width of lockable door	597	797	497	597
B8 = Punched length	500	700	900	1100
F1 = Mounting plate width	530	730	930	1130
F2 = Distance between mounting holes	475	675	875	1075
F3 = Distance between mounting holes	373	573	773	973