

### Piezas superiores

Ancho 600/800 mm  
TP 6720.500, TP 6721.500

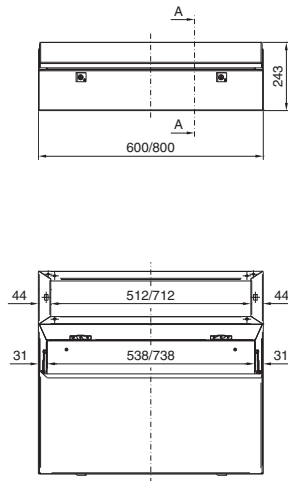

Ancho 1200/1600 mm  
TP 6722.500, TP 6723.500

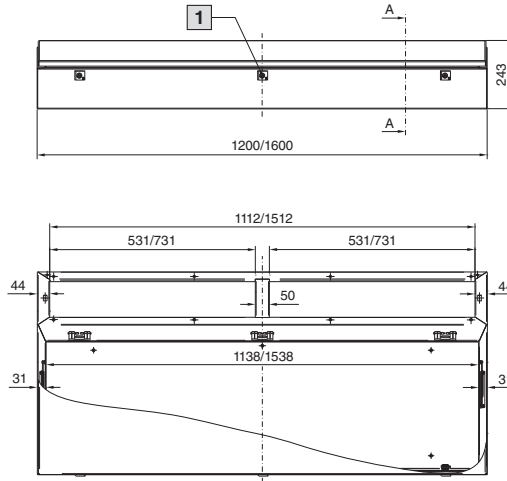

Sección A - A

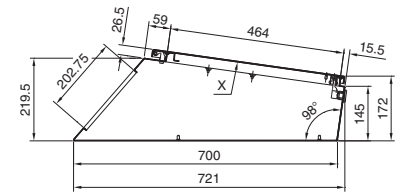

1 Sólo con ancho de 1600 mm

**Nota:**  
- Vista X, ver página 2

### Piezas centrales, preparadas para pieza superior

Ancho 600/800 mm  
TP 6714.500, TP 6715.500

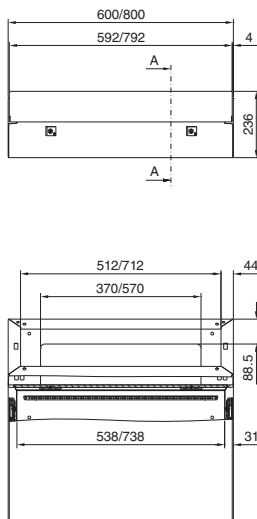

Ancho 1200/1600 mm  
TP 6716.500, TP 6717.500

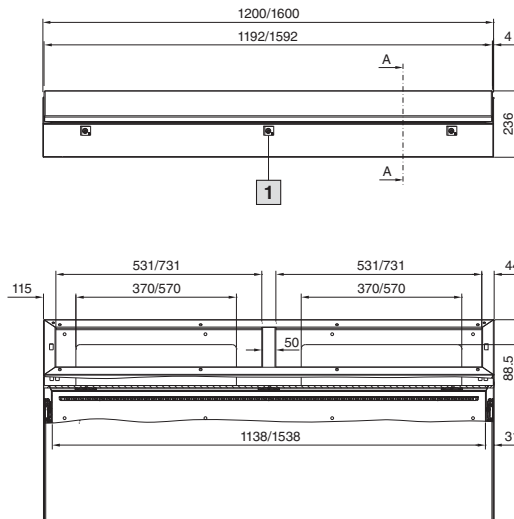

Sección A - A

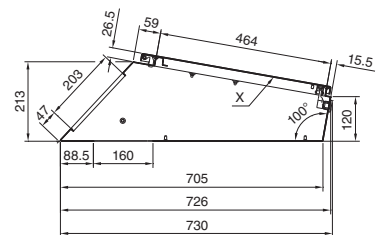

1 Sólo con ancho de 1600 mm

**Nota:**  
- Vista X, ver página 2

# Armarios de distribución

## Sistema TopPult TP

### Partes centrales, con cubierta con bisagras en la parte trasera

Ancho 600/800 mm  
TP 6710.500, TP 6711.500

Ancho 1200/1600 mm  
TP 6712.500, TP 6713.500

Sección A - A

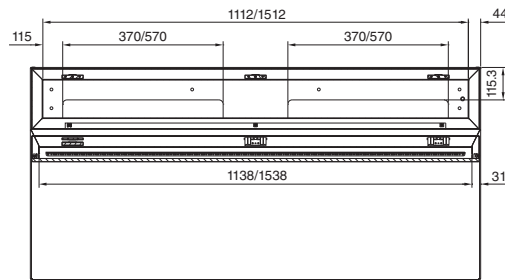
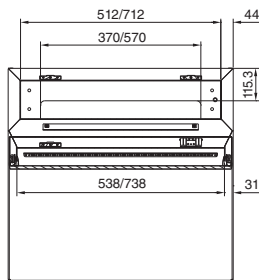
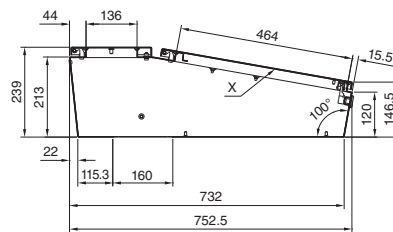
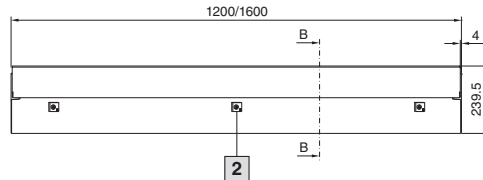
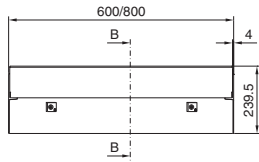

Vista X

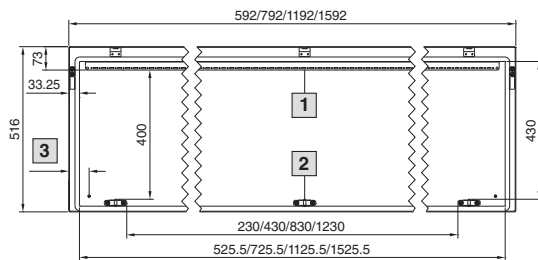

- 1 Desaparece en las anchuras 600/800 mm
- 2 Sólo con ancho de 1600 mm
- 3 Ancho = 600/800/1200 = 63,5 mm  
Ancho = 1600/163,5 mm

### Piezas inferiores, profundidad 400 mm

Ancho 600/800 mm  
TP 6700.500, TP 6701.500

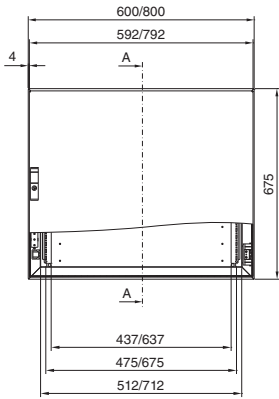

Ancho 1200/1600 mm  
TP 6702.500, TP 6703.500

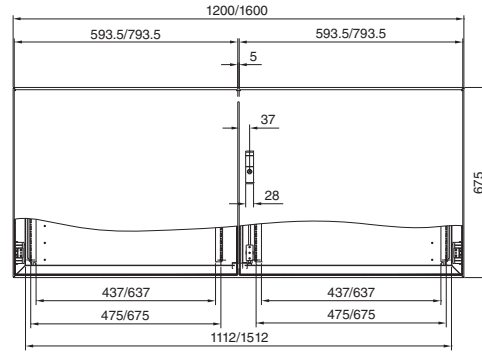

Sección A - A

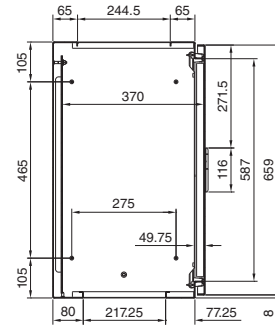

Sección de montaje

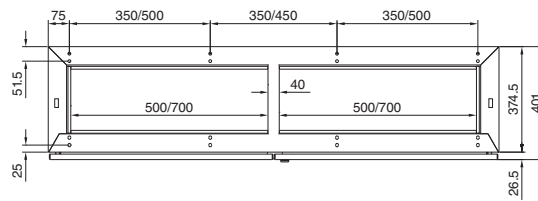
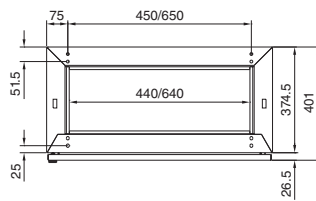
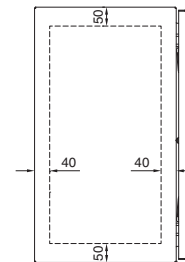

Placa de montaje

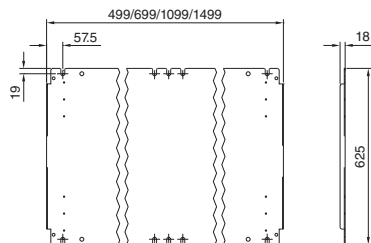

# Armarios de distribución

## Sistema TopPult TP

### Piezas inferiores, profundidad 500 mm

Ancho 600/800 mm  
TP 6704.500, TP 6705.500

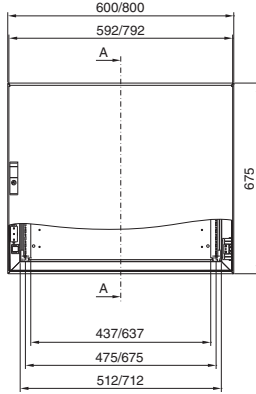

Ancho 1200/1600 mm  
TP 6706.500, TP 6707.500

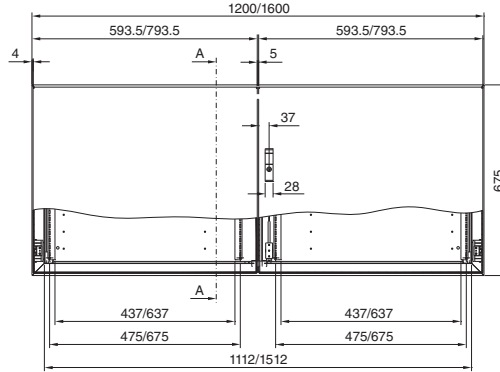

Sección A - A

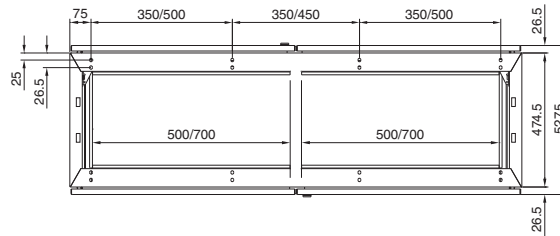
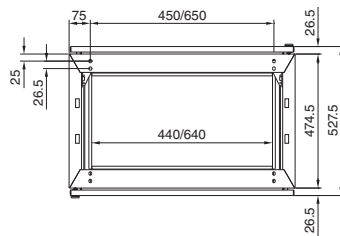
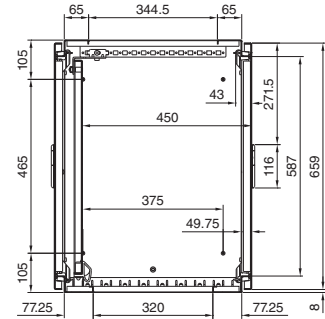

Sección de montaje

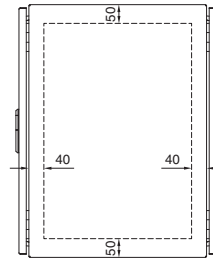

Placa de montaje

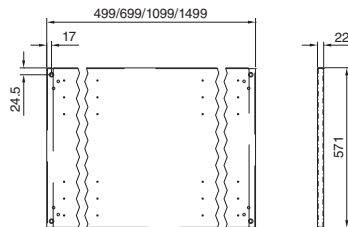

### Posibilidades de combinación

Montaje de 3 piezas

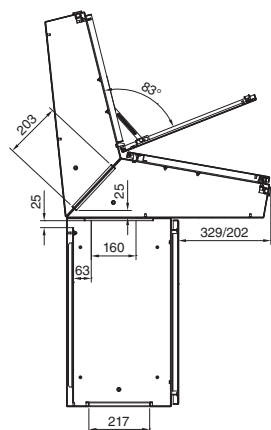
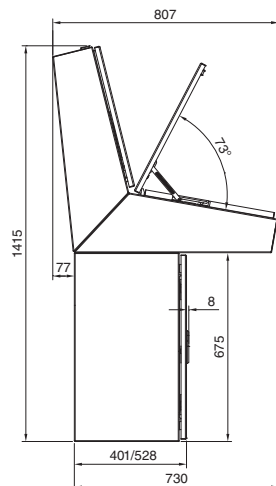

Montaje de 2 piezas

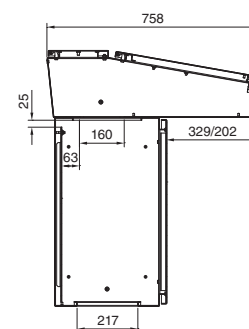
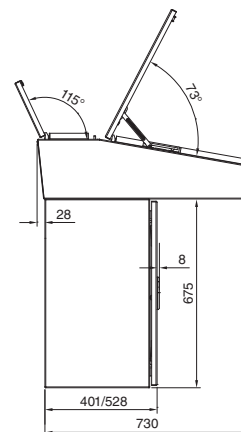

Montaje de 1 pieza

