

### Micro Data Center

#### Level E

Enkeltlåger fortil og bagtil

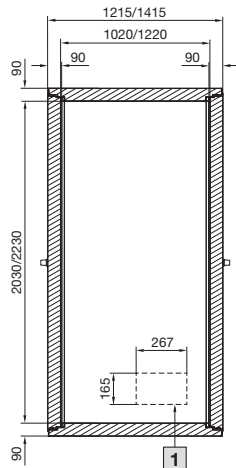
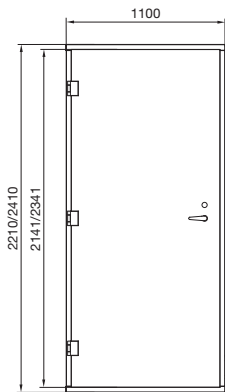

**1** Kabelgennemføring som kabelplade (standard)

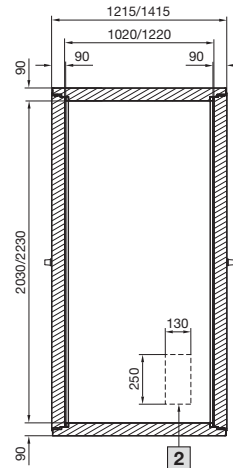

**2** Kabelgennemføring som kabelboks (tilvalg)

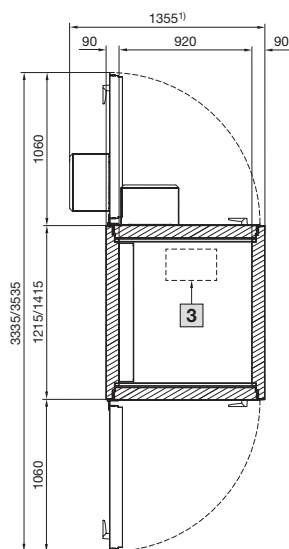

**3** Kabelgennemføring i top- eller bundelement som kabelplade/felter der kan udnyttes: 2x 120 x 120 mm (tilvalg)

<sup>1)</sup> Ved placering af køleenhedens udvendige enhed på lågen

## Micro Data Center

### Level E

Enkeltlåge fortil/dobbeltlåge bagtil

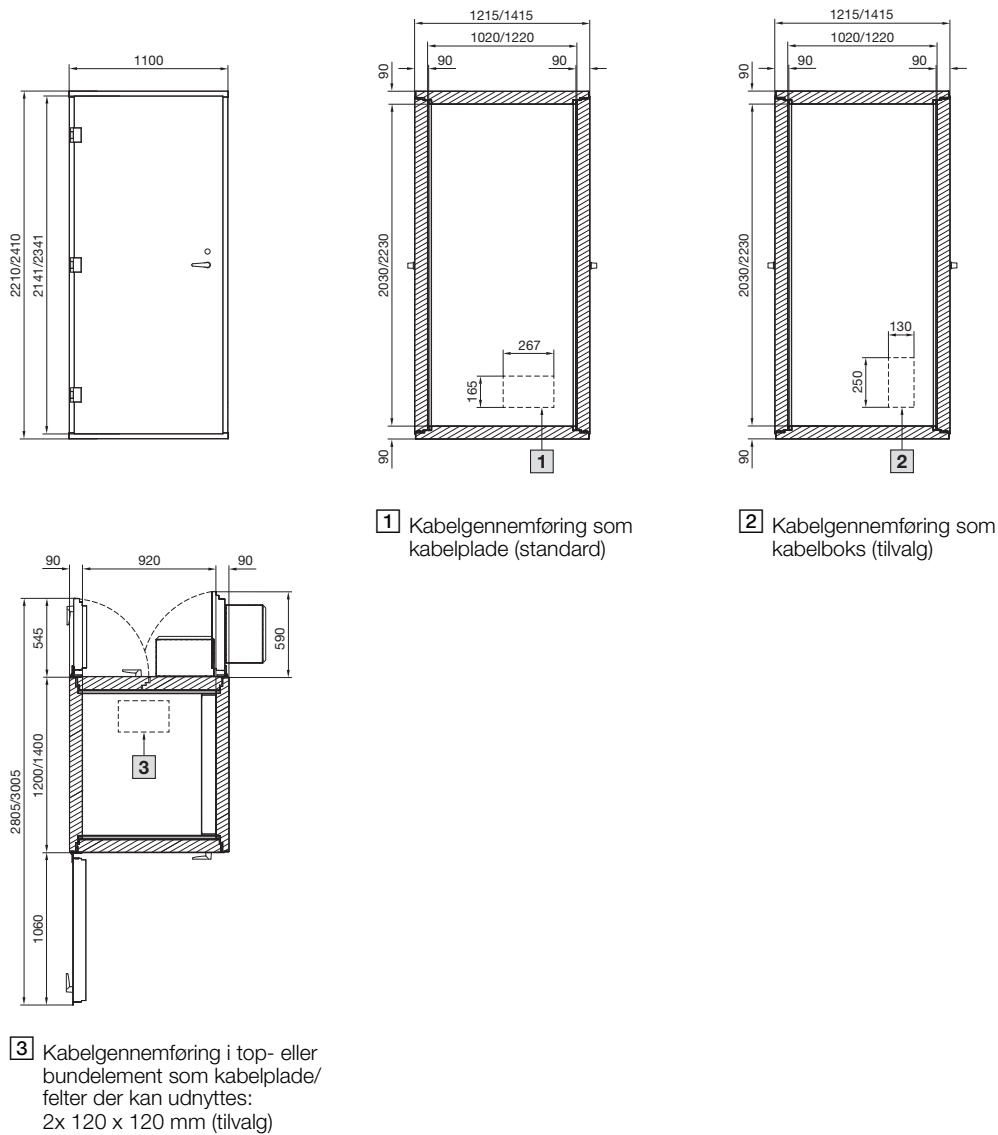

# IT-infrastruktur

## IT-sikkerhedsløsninger

### Micro Data Center

#### Level E

Dobbeltlåger fortil og bagtil

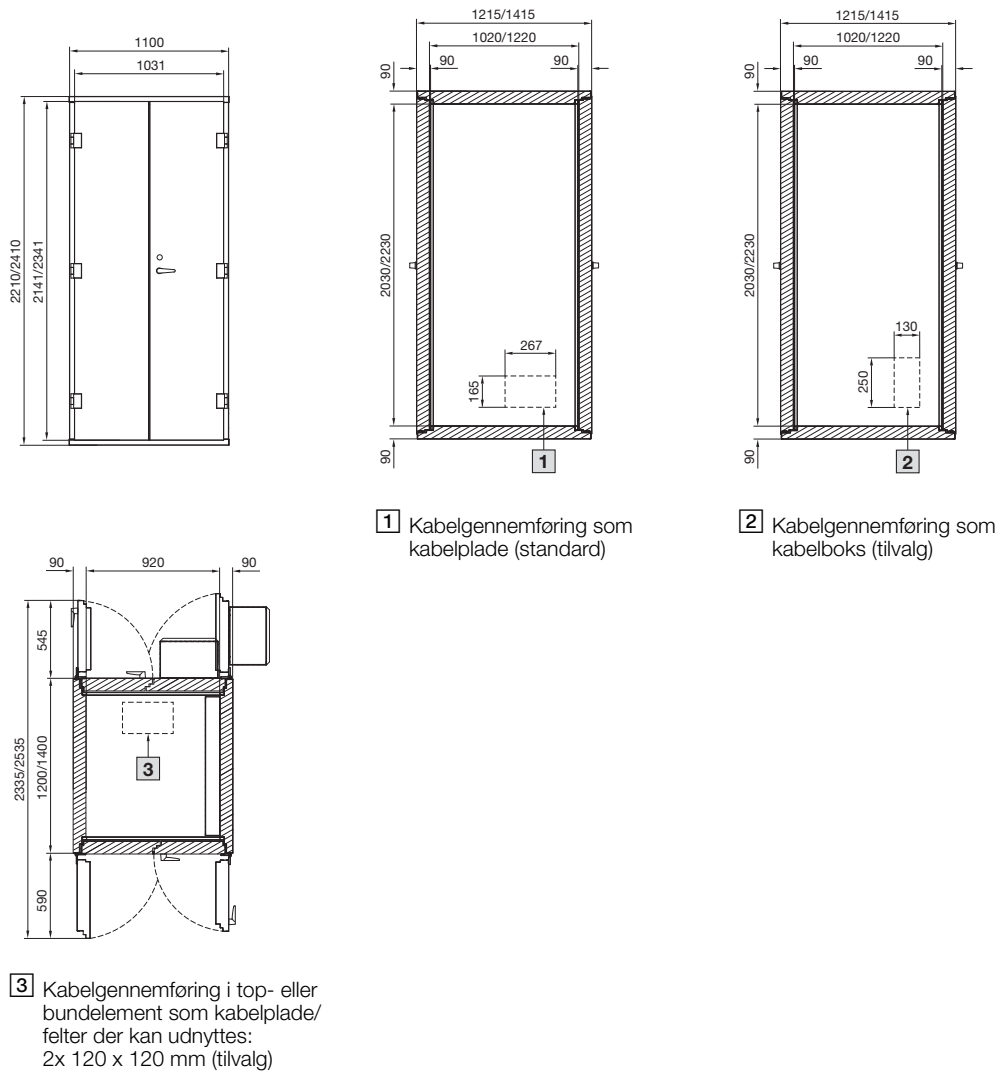

## Micro Data Center

Level B

Enkeltlåger fortil og bagtil

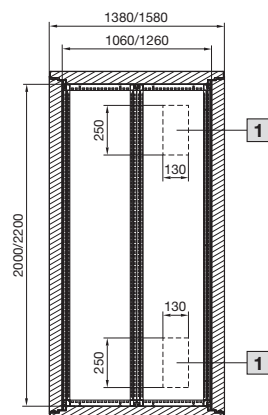
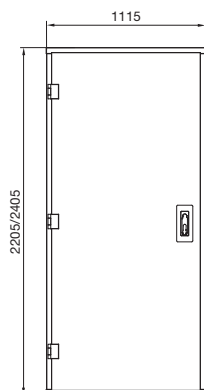

- 1 Kabelgennemføring
- 2 Kabelplade ved indv. dybde 1060 mm
- 2 Kabelplade ved indv. dybde 1260 mm (90° drejet)

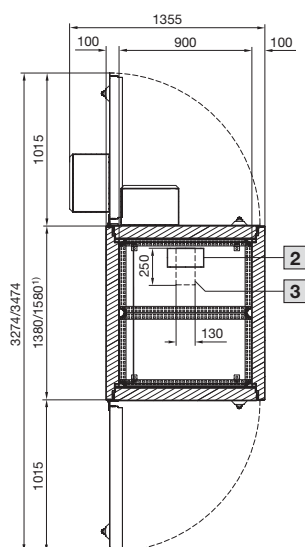

1) Mål inkl. låse

### Micro Data Center

#### Level B

Enkeltlåge fortil/dobbeltlåge bagtil

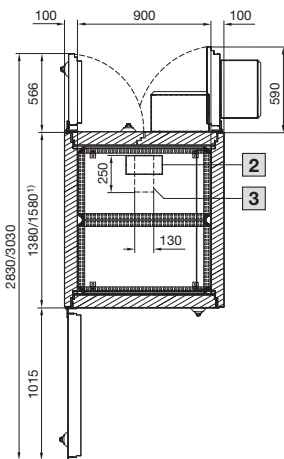
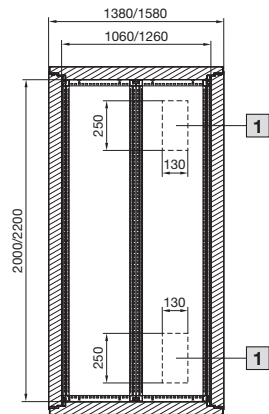
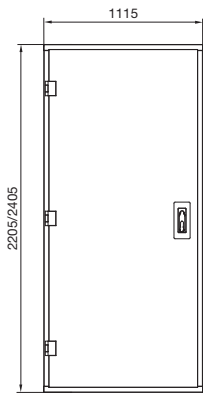

- 1 Kabelgennemføring
- 2 Kabelplade ved indv. dybde 1060 mm
- 2 Kabelplade ved indv. dybde 1260 mm (90° drejet)
- 3

1) Mål inkl. låse

## Micro Data Center

## Level B

Dobbeltlåger fortil og bagtil

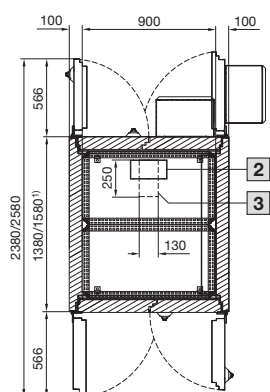
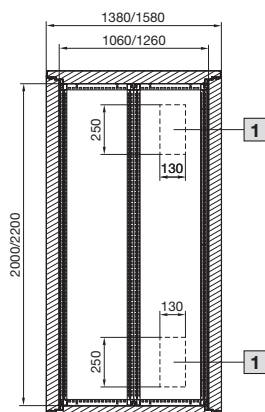
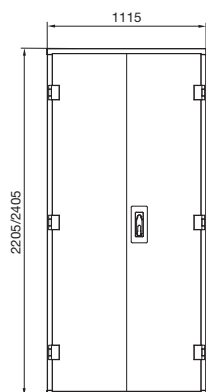

- 1 Kabelgennemføring
- 2 Kabelplade ved indv. dybde 1060 mm
- 2 Kabelplade ved indv. dybde 1260 mm (90° drejet)

1) Mål inkl. låse