

Pulpetin yläosat

Leveys 600/800 mm
TP 6720.500, TP 6721.500

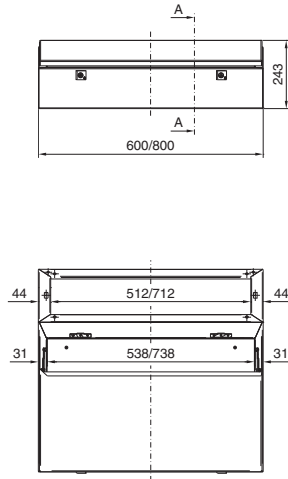

Leveys 1200/1600 mm
TP 6722.500, TP 6723.500

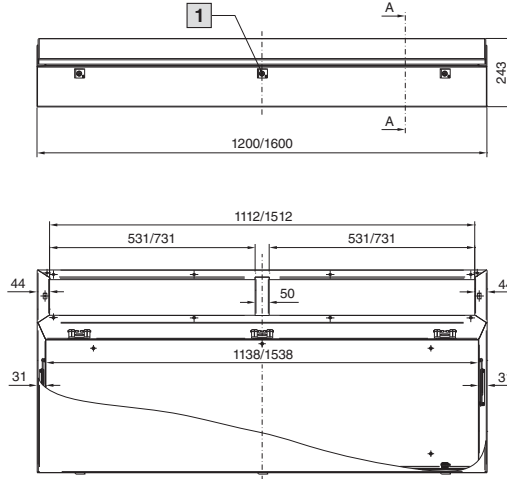

Leikkaus A - A

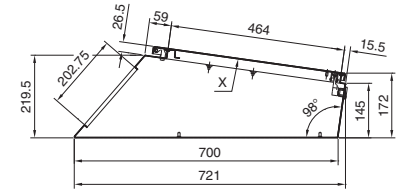

1 Vain leveys 1600 mm

Ohje:
- Näkymä X, katso sivu 2

Pulpetin keskiosat, valmisteltu pulpetin yläosaa varten

Leveys 600/800 mm
TP 6714.500, TP 6715.500

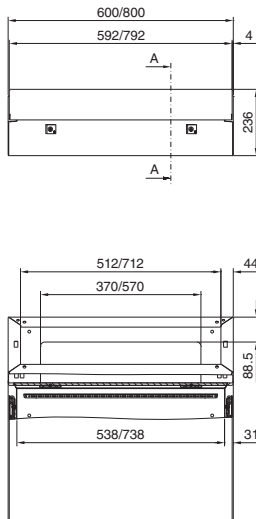

Leveys 1200/1600 mm
TP 6716.500, TP 6717.500

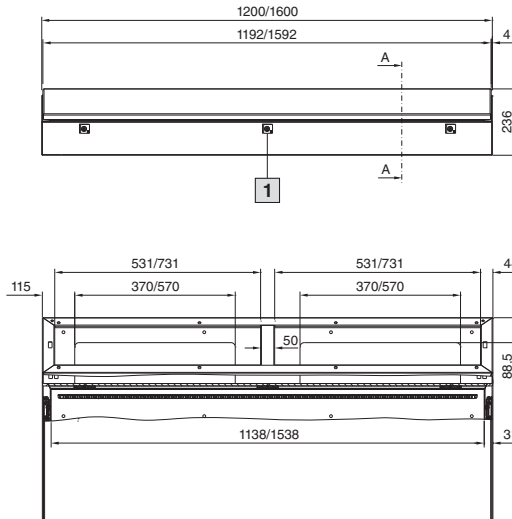

Leikkaus A - A

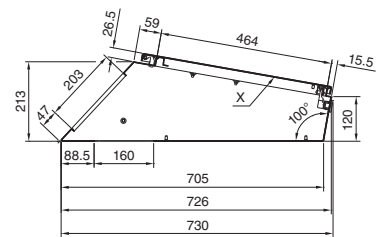

1 Vain leveys 1600 mm

Ohje:
- Näkymä X, katso sivu 2

KytKentäkaapit

TopPult-järjestelmä TP

Pulpetin keskiosat, takaa saranoidulla kannella

Leveys 600/800 mm
TP 6710.500, TP 6711.500

Leveys 1200/1600 mm
TP 6712.500, TP 6713.500

Leikkaus A – A

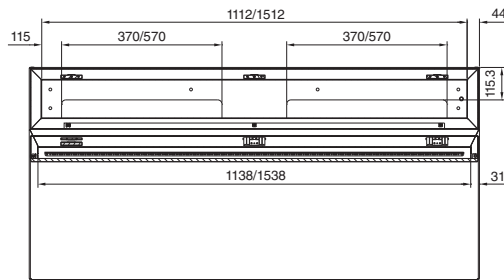
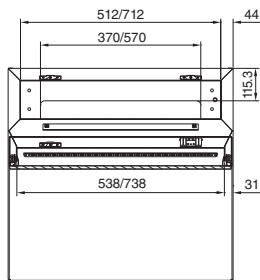
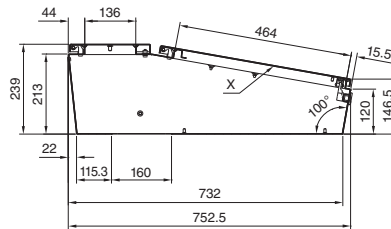
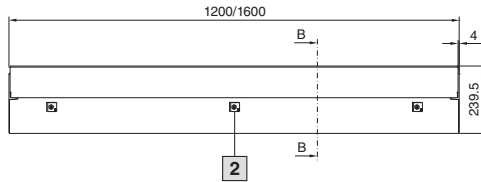
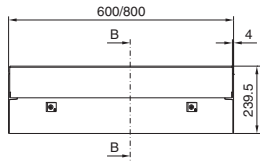

Näkymä X

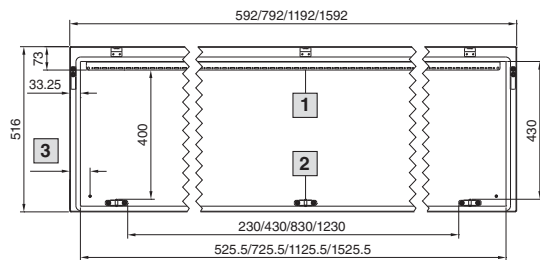

- 1 Ei leveydessä 600/800 mm
- 2 Vain leveys 1600 mm
- 3 Leveys = 600/800/1200 = 63,5 mm
Leveys = 1600/163,5 mm

Pulpetin alaosat, syvyys 400 mm

Leveys 600/800 mm
TP 6700.500, TP 6701.500

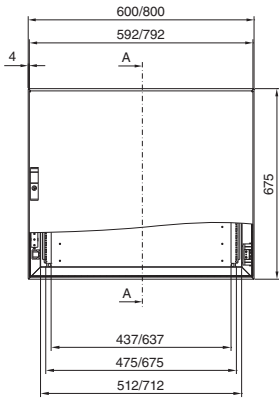

Leveys 1200/1600 mm
TP 6702.500, TP 6703.500

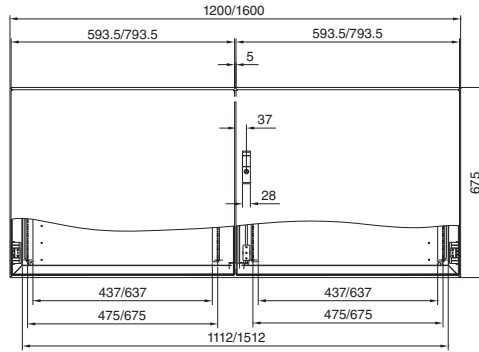

Leikkaus A – A

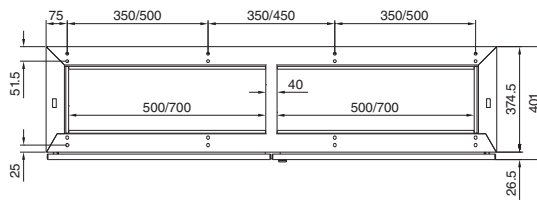
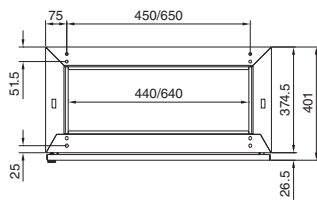
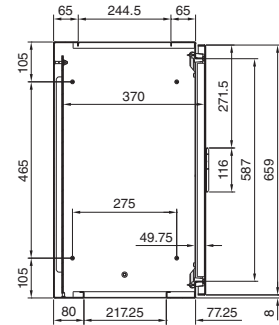

Asennusaukotus

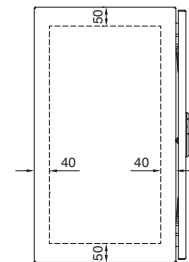

Asennuslevy

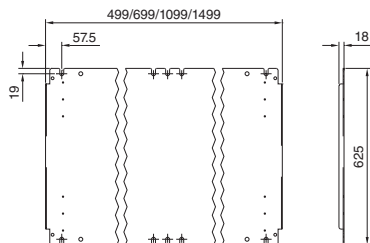

Kytentäkaapit

TopPult-järjestelmä TP

Pulpetin alaosat, syvyys 500 mm

Leveys 600/800 mm
TP 6704.500, TP 6705.500

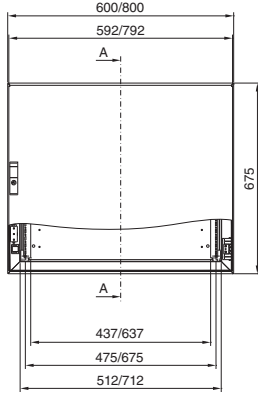

Leveys 1200/1600 mm
TP 6706.500, TP 6707.500

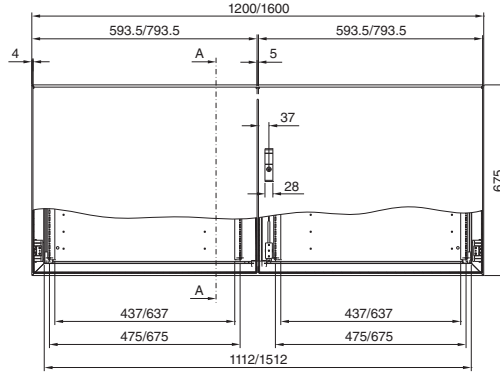

Leikkaus A – A

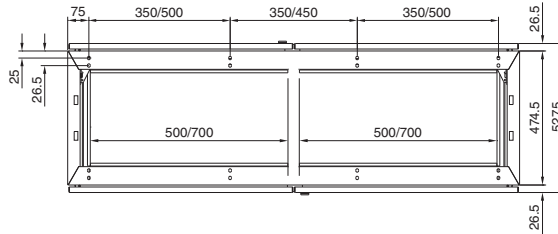
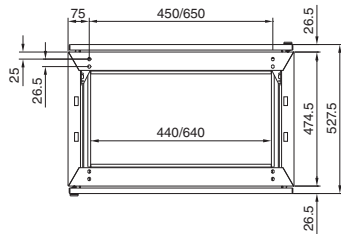
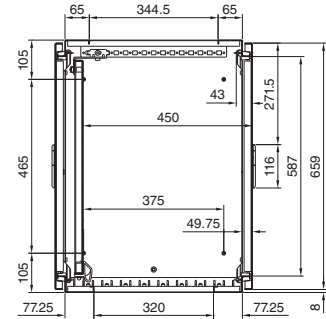

Asennusleikkaus

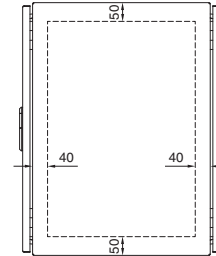

Asennuslevy

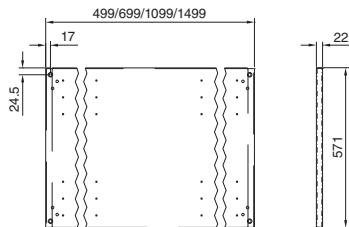

Yhdistämismahdollisuudet

Rakenne 3-osainen

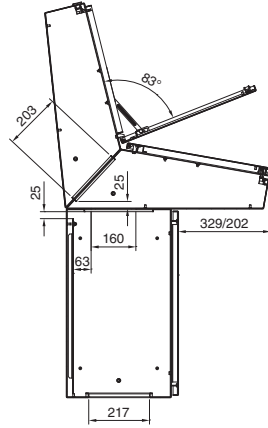
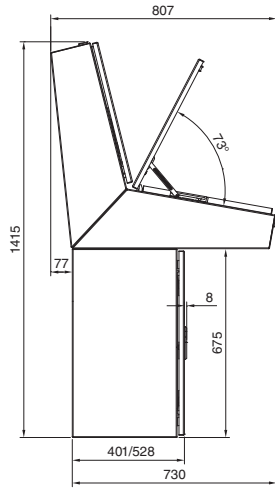

Rakenne 2-osainen

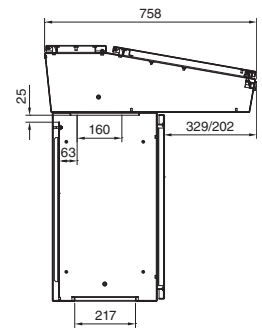
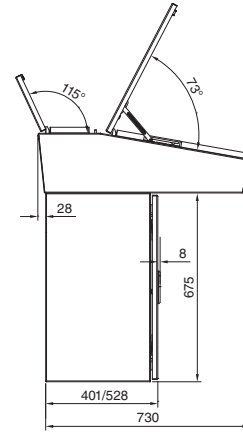

Rakenne 1-osainen

