

Rittal – The System.

Faster – better – everywhere.



RX 9365.741

Estado: 16/07/2025 (Fuente: rittal.com/es-es)

ENCLOSURES

POWER DISTRIBUTION

CLIMATE CONTROL

IT INFRASTRUCTURE

SOFTWARE & SERVICES

FRIEDHELM LOH GROUP



RX 9365.741 -

Height-adjustable support rails for component adaptors in width 45 mm. Ideal for securing motor-starter combinations with varying mounting levels. For mounting top-mounted equipment with snap fastening on component adaptors and component supports for RiLineX and 60 mm busbar system platforms.

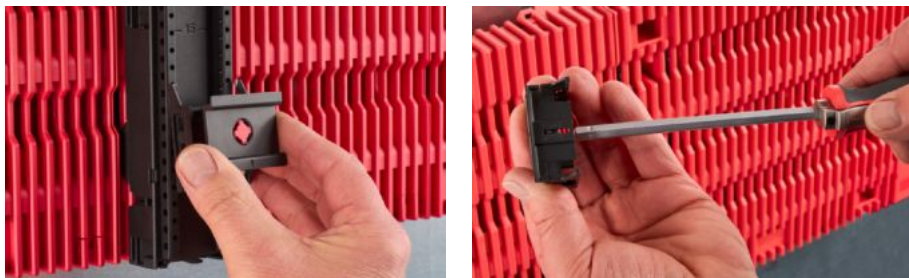

Características

Referencia	RX 9365.741
Ejecución	con ajuste de altura
Material	Poliamida (PA 6) Protección frente al fuego según UL 94
Color	RAL 9005 RAL 35745
Adecuados para referencia	9360710 9360720 9360730
Dimensiones	Anchura: 45 mm Altura: 12 mm, 20 mm
Unidad de embalaje	8 pza(s).
Peso neto	0.144
Peso bruto	0.148
Código arancelario	39269097
ETIM 9	EC001285

Aprobaciones

Explicaciones

Declaración de conformidad