

Rittal – The System.

Faster – better – everywhere.

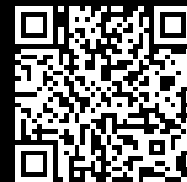

RX 9365.741

RiLineX support rail for component adaptor

State: 07.09.2025. (Source: [rittal.com/hr-hr](https://www.rittal.com/hr-hr))

ENCLOSURES

POWER DISTRIBUTION

CLIMATE CONTROL

IT INFRASTRUCTURE

SOFTWARE & SERVICES

FRIEDHELM LOH GROUP



RX 9365.741 - RiLineX support rail for component adaptor

RiLineX support rails for component adaptors in width 45 mm for 60 mm busbar systems. Height-adjustable, ideal for securing motor-starter combinations with different mounting levels. For mounting top-mounted equipment with snap fastening on component adaptors and component supports.

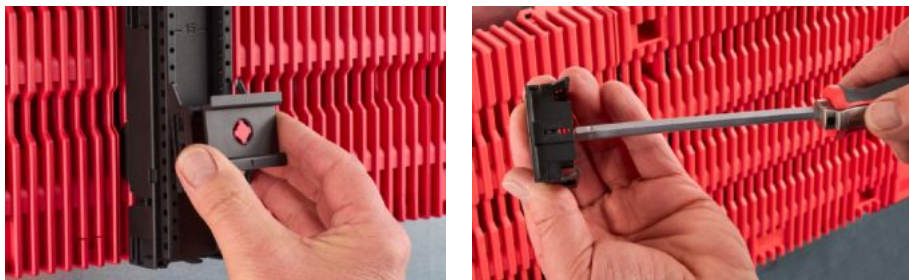

Features

Model No.	RX 9365.741
Design	with height adjustment system
Material	Polyamide (PA 6) Fire protection corresponding to UL 94
Colour	RAL 9005 RAL 35745
To fit Model No.	9360710 9360720 9360730
Dimensions	Width: 45 mm Height: 12 mm, 20 mm
Packs of	8 pc(s).
Net weight	0.144
Gross weight	0.148
Customs tariff number	39269097
ETIM 9	EC001285

Approvals

Explanations

Declaration of conformity