

Rittal – The System.

Faster – better – everywhere.



RX 9365.741

RiLineX support rail for component adaptor

State: 2025/09/07 (Source: [rittal.com/jp-ja](https://www.rittal.com/jp-ja))

ENCLOSURES

POWER DISTRIBUTION

CLIMATE CONTROL

IT INFRASTRUCTURE

SOFTWARE & SERVICES

FRIEDHELM LOH GROUP



RX 9365.741 - RiLineX support rail for component adaptor

RiLineX support rails for component adaptors in width 45 mm for 60 mm busbar systems. Height-adjustable, ideal for securing motor-starter combinations with different mounting levels. For mounting top-mounted equipment with snap fastening on component adaptors and component supports.

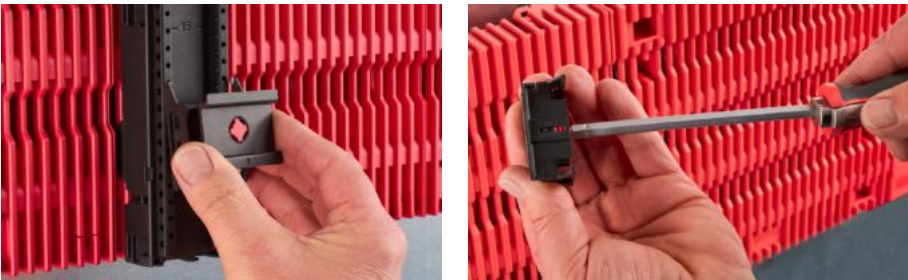

Features

品番	RX 9365.741
仕様	高さ位置変更可能
材質	ポリアミド (PA 6) 耐燃性 UL 94 適合
塗装色	RAL 9005 RAL 35745
適用品番	9360710 9360720 9360730
寸法：	幅: 45 mm 高さ: 12 mm, 20 mm
1パック	8 個
純質量	0.144

Features

総質量	0.148
関税率番号	39269097
ETIM 9	EC001285

Approvals

Explanations	CE適合宣言書
--------------	---------