

# Rittal – The System.

Faster – better – everywhere.



## PS 4120.000 Wiring plan lectern

State: 2026.5.15 (Source: [rittal.com/lt-en](http://rittal.com/lt-en))

ENCLOSURES

POWER DISTRIBUTION

CLIMATE CONTROL

IT INFRASTRUCTURE

SOFTWARE & SERVICES

FRIEDHELM LOH GROUP



# PS 4120.000 - Wiring plan lectern for VX, TS, VX SE, TP, PC

Holds wiring plans during fault-finding and maintenance work. Wiring plan lecterns may be bayed in line with the door width. For mounting on the tubular door frame or on the perforated door strip.

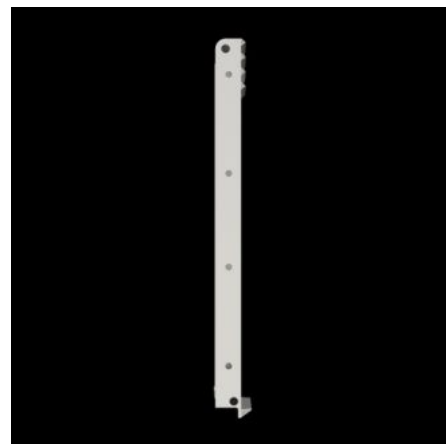

## Features

Model No.	PS 4120.000
Product description	Holds wiring plans during fault-finding and maintenance work. Wiring plan lecterns may be bayed in line with the door width. For mounting on the tubular door frame or on the perforated door strip.
Material	Utility lectern: Polypropylene Mounting bracket: Die-cast zinc
Colour	Similar to RAL 7035
Supply includes	Assembly parts
To fit door width	400 mm 500 mm 600 mm 800 mm 1,000 mm
Installation options	This number of wiring plan lecterns must be used on the tubular door frame Door width 400/500 mm = 1 wiring plan lectern Door width 600 mm = 2 wiring plan lecterns Door width 800 mm = 2 or 3 wiring plan lecterns Door width 1000 mm = 3 wiring plan lecterns

# Features

Dimensions	Width: 210 mm Height: 365 mm Depth: 24 mm
To fit	Enclosure type: VX TS VX SE TP PC
Packs of	1 pc(s).
Net weight	0.84 kg
Gross weight	0.86 kg
Customs tariff number	39269097
ETIM 9	EC000317
ETIM 8	EC000317
ECLASS 8.0	27189267
Product description	PS Wiring plan lectern, for VX, TS, VX SE, PC, TP, for door width: 400 mm