

Rittal – The System.

Faster – better – everywhere.



RX 9365.741

RiLineX support rail for component adaptor

State: 7/09/2025 (Source: rittal.com/uk-en)

ENCLOSURES

POWER DISTRIBUTION

CLIMATE CONTROL

IT INFRASTRUCTURE

SOFTWARE & SERVICES

FRIEDHELM LOH GROUP



RX 9365.741 - RiLineX support rail for component adaptor

RiLineX support rails for component adaptors in width 45 mm for 60 mm busbar systems. Height-adjustable, ideal for securing motor-starter combinations with different mounting levels. For mounting top-mounted equipment with snap fastening on component adaptors and component supports.

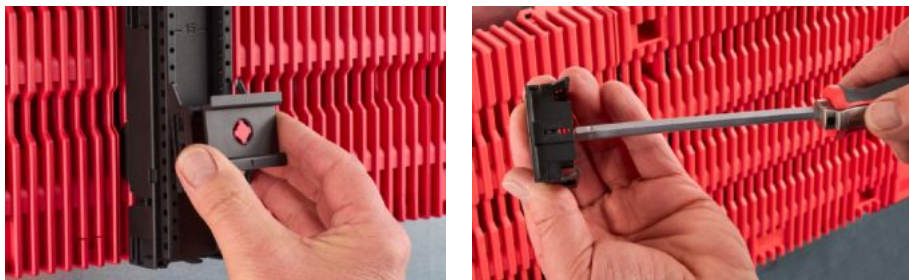

Features

| | |
|-----------------------|--|
| Model No. | RX 9365.741 |
| Design | with height adjustment system |
| Material | Polyamide (PA 6) Fire protection corresponding to UL 94 |
| Colour | RAL 9005 RAL 35745 |
| To fit Model No. | 9360710 9360720 9360730 |
| Dimensions | Width: 45 mm Height: 12 mm, 20 mm |
| Packs of | 8 pc(s). |
| Net weight | 0.144 |
| Gross weight | 0.148 |
| Customs tariff number | 39269097 |
| ETIM 9 | EC001285 |

Approvals

Explanations

Declaration of conformity