

Rittal – The System.

Faster – better – everywhere.



SV 9685.532

PE/PEN busbar E-Cu, tin-plated

State: 6/5/2026 (Source: rittal.com/us-en)

ENCLOSURES

POWER DISTRIBUTION

CLIMATE CONTROL

IT INFRASTRUCTURE

SOFTWARE & SERVICES

FRIEDHELM LOH GROUP



SV 9685.532 - PE/PEN busbar E-Cu, tin-plated

With integrated holes.

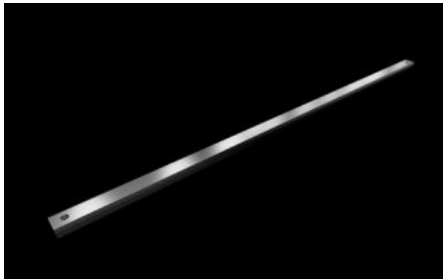

Features

Model No.	SV 9685.532
Material	E-Cu, tin-plated
Dimensions	Length: 1,100 mm Length: 43.3 "
Cross-section	30 mm x 10 mm 1.18 " x 0.39 "
Packaging unit	2 pc(s).
Net weight	5.8 kg
Gross weight	5.86 kg
Copper weight (kg per piece)	2.94
Customs tariff number	74071000
Product description	SV PE/PEN busbar E-Cu tin-plated, WH: 30 x 10 mm, L: 1100 mm

Approvals

Approvals	UL + C-UL (listed)
-----------	--------------------